

Village of Elk Mound ATV-UTV Route Map 2021

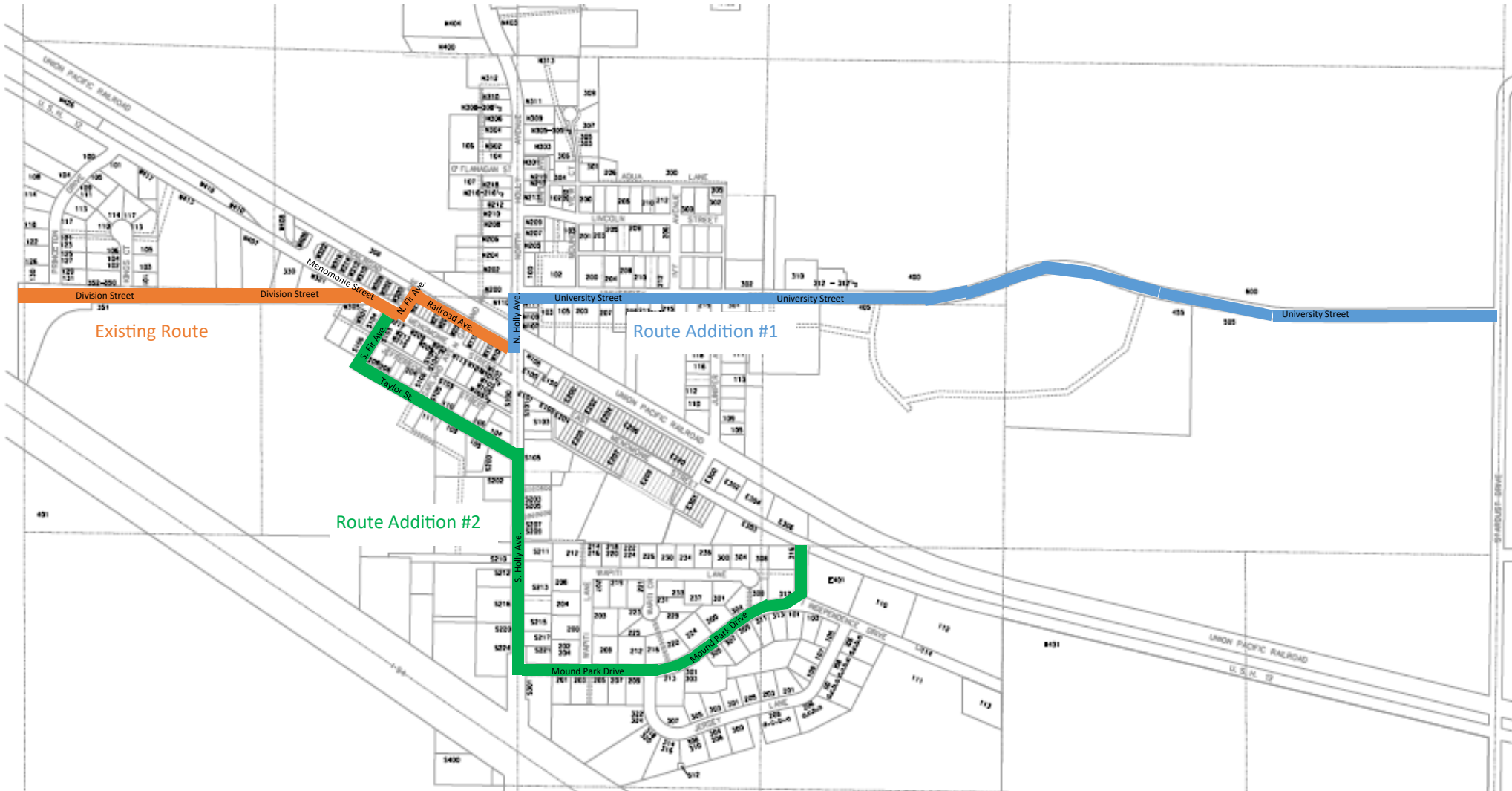

Existing Route = Division Street to N. Fir to Railroad Ave. End at Holly Ave.

Proposed Route Addition #1 = N. Holly Avenue to University Street to 970th Avenue to 930th Avenue

Proposed Route Addition #2 = S. Fir to Taylor, to South Holly to Mound Park Drive End at Menomonie Street (Hwy 12).